

4

3

2

1



FlightWave

D

D

C

C

B

B

A

A

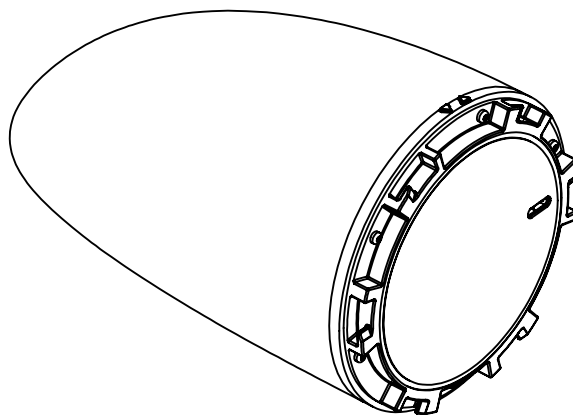

Nosecone

M2x6mm Self-Threading Screw  
McMaster Part 96817A844

Payload Wall

USB-C Payload Connector  
Recommended Part:  
EDAC 690-024-294T331  
Digi-Key Part 151-1601-2-NDM2x6mm Self-Threading Screw  
McMaster Part 96817A844Metric O-Ring  
2mm CS x 70mm ID  
Recommended Part:  
TheOringStore N2.00X070

COMMENTS:		NAME	DATE	FLIGHTWAVE AEROSPACE SYSTEMS CORP.		
	DESIGNED	TWL, DL	12/26/2018	EDGE PAYLOAD INTERFACE		
	DRAWN	TWL	12/26/2018			
DO NOT SCALE DRAWING	CHECKED			SCALE: 1:2	UNITS: MM	SHEET 1 OF 4

4

3

2

1

4

3

2

1



FlightWave

Note: Nosecone shape can be modified to accomodate payload bodies

Top View

143.5

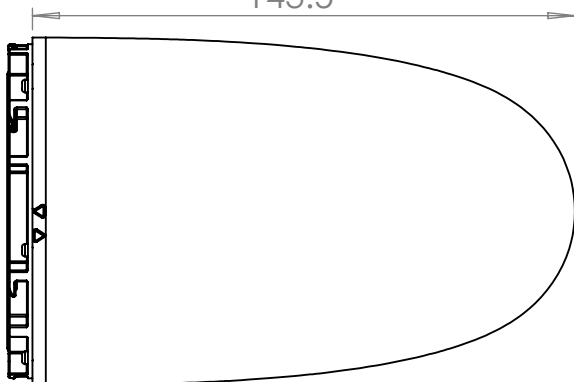

Right Side View

1.5

Nominal Wall Thickness

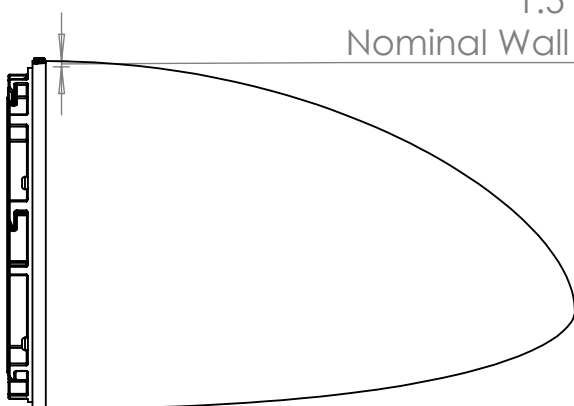

Rear View

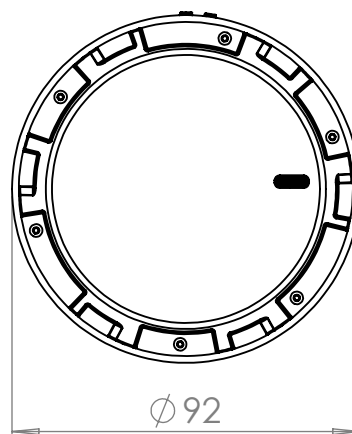
 $\phi 92$ 

COMMENTS:

NAME

DATE

FLIGHTWAVE AEROSPACE SYSTEMS CORP.

DESIGNED

TWL, DL

12/26/2018

EDGE PAYLOAD INTERFACE

DRAWN

TWL

12/26/2018

DO NOT SCALE DRAWING

CHECKED

SCALE: 1:2

UNITS: MM

SHEET 2 OF 4

4

3

2

1

4

3

2

1



FlightWave

Outer Payload Wall View

Inner Payload Wall View

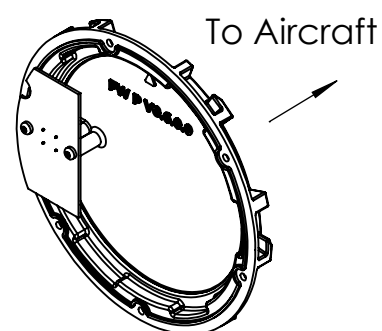
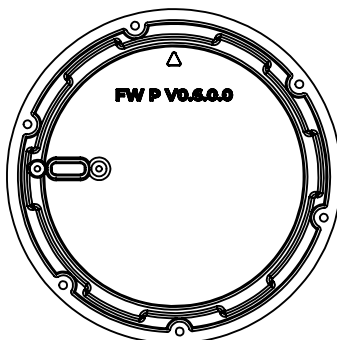
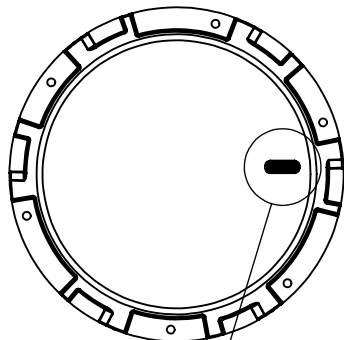

## Payload Pin Assignment

"PH:" notes signals from the Pixhawk Autopilot

"CM:" notes signals from the Compute Module

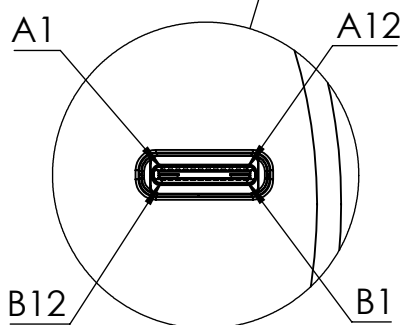

Connector Detail  
SCALE 2 : 1

Pin	Signal	Voltage	Pin Current
A1	Battery Ground	GND	0.75A
A2	Signal Ground	Digital GND	Signal
A3	PH: AUX PWM 3	3.3V	Signal
A4	Battery V+ Fused	10.0V to 16.8V	0.75A
A5	PH: AUX PWM 5	3.3V	Signal
A6	Future	N/C	N/C
A7	Future	N/C	N/C
A8	PH: AUX PWM 6	3.3V	Signal
A9	Battery V+ Fused	10.0V to 16.8V	0.75A
A10	PH: CAN 1 H	3.3V	Signal
A11	PH: CAN 1 L	3.3V	Signal
A12	Battery Ground	GND	0.75A
B1	Battery Ground	GND	0.75A
B2	PH: I2C 2 SDA	3.3V	Signal
B3	PH: I2C 2 SCL	3.3V	Signal
B4	Battery V+ Fused	10.0V to 16.8V	0.75A
B5	PH: SERIAL 4 TX	3.3V	Signal
B6	CM: USB D+	5V	Signal
B7	CM: USB D-	5V	Signal
B8	PH: SERIAL 4 RX	3.3V	Signal
B9	Battery V+ Fused	10.0V to 16.8V	0.75A
B10	PH: AUX PWM 2	3.3V	Signal
B11	PH: AUX PWM 1	3.3V	Signal
B12	Battery Ground	GND	0.75A

COMMENTS:

NAME

DATE

FLIGHTWAVE AEROSPACE SYSTEMS CORP.

DESIGNED

TWL, DL

12/26/2018

EDGE PAYLOAD INTERFACE

DRAWN

TWL

12/26/2018

DO NOT SCALE DRAWING

CHECKED

SCALE: 1:2

UNITS: MM

SHEET 3 OF 4

4

3

2

1

4

3

2

1



FlightWave

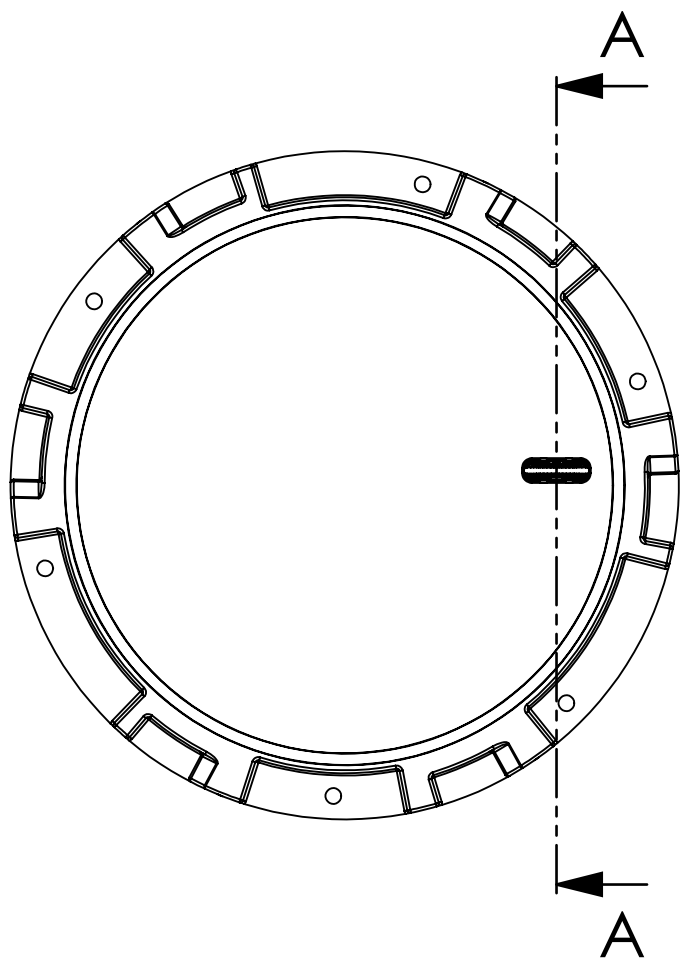

5.90 ±0.05  
USB-C Plug  
Insertion Depth

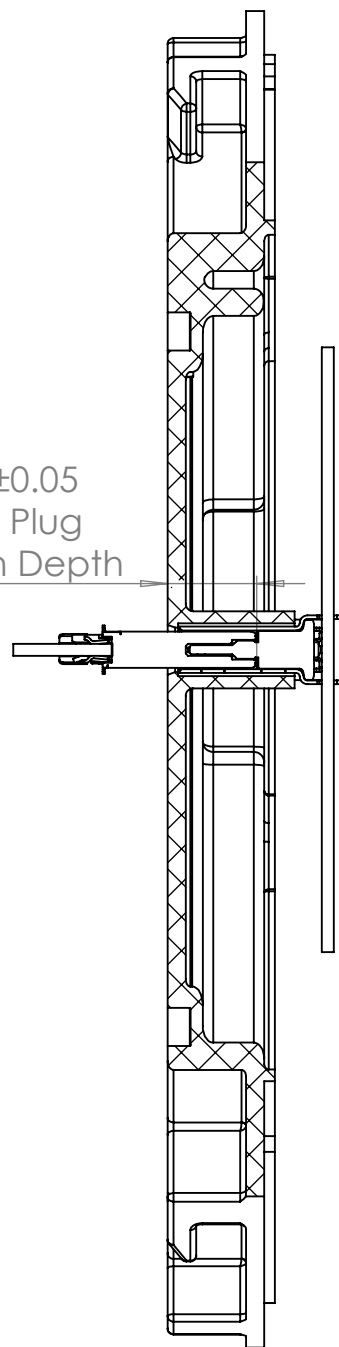

## SECTION A-A

SCALE 2 : 1

COMMENTS:

NAME

DATE

FLIGHTWAVE AEROSPACE SYSTEMS CORP.

DESIGNED

TWL, DL

12/26/2018

DRAWN

TWL

12/26/2018

EDGE PAYLOAD INTERFACE

DO NOT SCALE DRAWING

CHECKED

SCALE: 1:1

UNITS: MM

SHEET 4 OF 4

4

3

2

1

D

D

C

C

B

B

A

A